

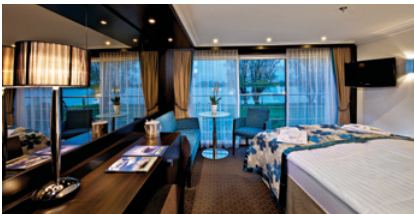

YOUNGEST FLEET, INSPIRED DESIGN

Avalon Waterways boasts the youngest fleet of ships on Europe's rivers. In an industry with an average ship age of seven years, our average ship age is a mere 2.5 years. We've also redefined the river cruise industry by designing our ships - and the entire river cruise experience - around our guests. We call it "Inspired Design." Not only do we boast the largest staterooms and suites on Europe's waters, our amenities are countless, including fitness centres, flat-screen televisions, Sky Decks with shade systems, premium lounge chairs, whirlpools, free Wi-Fi and so much more.



DESIGN

We started with the traveller, instead of the ship.

Instead of listening to accountants who want more people and less space, we listened to our travellers. We let innovation, imagination and a relentless desire to create a smart use of space be our guide. The result is the Panorama Suite - 200 square feet of luxury.



LUXURY & COMFORT

Two words we take seriously and so do our travellers.

Our staterooms and suites offer deluxe Comfort Collection BedsSM with Egyptian super-combed cotton linens, European-style duvets and choice of pillows, plush robes, slippers, complimentary bottled water and nightly turndown service. Luxury bathrooms feature marble countertops and premium L'Occitane toiletries.



OPEN-AIR-BALCONYSM

While others ask you to compromise, we present staterooms that never will.

We created innovative Open-Air BalconiesSM without compromising room space. Travellers can slide the doors wide open and enjoy the feeling of sitting comfortably "outside" as the amazing views of castles, villages, rolling green hills and ancient cities pass by.



VIEWS

River cruising is all about the ever-changing views.

While other cruise ships give their guests a view that never changes, we took a different approach and angled our beds to face the giant window. In doing that, we gave our travellers more space and a better view from the comfort of bed. That's what happens when you pay attention to the details.



AVALON CHOICE[®]

Avalon cruisers enjoy the luxury of choice.

From deciding what and where to eat, to selecting room configuration and cruising style; from choosing on-land discoveries and on-board enrichments to making online, pre-sail customisations via MyAccount, every Avalon experience, every nuance is up to - and is inspired by - our guests.

For bookings call **1300 130 134**
or go to
www.globusfamily.com.au/onlinebookings

AVALON
WATERWAYS[®]

10TH
ANNIVERSARY



AVALON

SUITE SHIPSSM

AVALON
IMPRESSION[®]

AVALON
ILLUMINATIONSM

AVALON
POETRY IISM

AVALON
PANORAMASM

AVALON
VISTASM

AVALON
VISIONARY[®]

AVALON
ARTISTRY II[®]

AVALON
EXPRESSIONSM

They're the pride of the fleet.

Avalon Waterways broke new ground in 2011 with the launch of its Suite Ship concept, changing the face of European river cruising. With the debut of Avalon Poetry IISM, IlluminationSM and Impression[®] in 2014, we'll offer eight magnificent Suite ShipsSM and a better-than-ever choice of itineraries on the great rivers of Europe.

PANORAMA SUITE



The Panorama Suite features contemporary design and décor, with an 11' floor to ceiling sliding glass door. This innovative design creates an Open-Air BalconySM while preserving an internal cabin space 30% larger than industry standard.

ROYAL SUITE



For anyone who likes to travel in style. At 300 square feet, this is the ultimate in river cruising. It offers a king bed, a double bathroom, an open living area and a host of extras like two flat-screen TVs and a complimentary iPad. Perfect for entertaining, it has the largest Open-Air BalconySM of all.

SUITE SHIP FEATURES

- Two full decks of Panorama Suites
- Wall-to-wall panoramic windows opening to create unique Open-Air BalconiesSM in every suite
- Spacious, open-seating dining room with full panoramic windows
- Sky Deck with shade system and premium lounge chairs
- Sky Deck whirlpool
- Sky Bistro on Sky Deck
- Expanded fitness centre
- Well-stocked library
- Two lounges and upscale bar serving premium spirits
- Internet corner and complimentary Wi-Fi access
- Hair salon

Panorama Suite

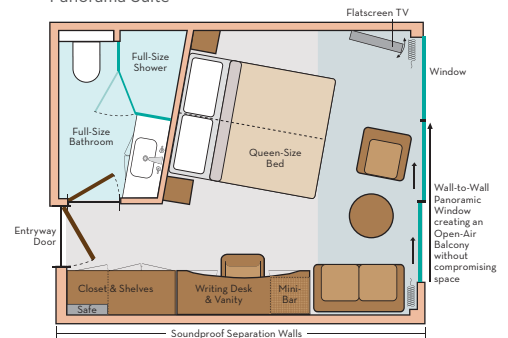

Royal Suite

